



NATIONAL ALUMINIUM
PRODUCTS COMPANY SAOG

N 70.2 mm Series

02-2018-V.01

All rights reserved.

No part of this publication may be reproduced, stored in a retrieval system or transmitted in any form or by any means electronic, mechanical, photocopying, recording or otherwise, without prior permission of NAPCO.

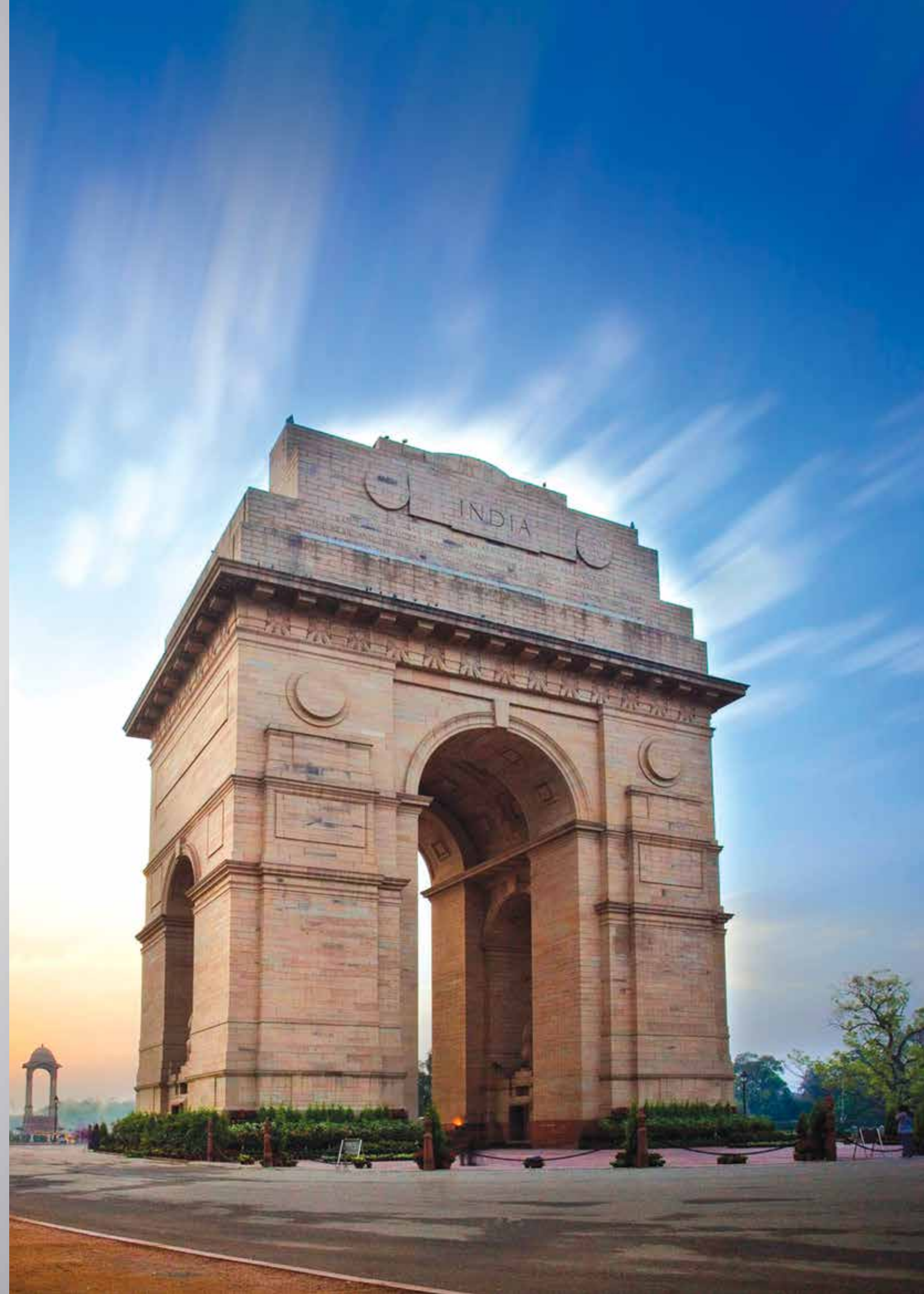



Index

Company Profile	05
Technical Information	06
N 70.2 mm Series	09

About Us

National Aluminium Products Company SAOG (NAPCO) was established in 1984 and is one of the leading extruders of aluminium profiles in the GCC market. Located in the Sultanate of Oman, the manufacturing plant is spread over 65,000 sq meters in the Rusayl Industrial estate.

NAPCO offers a wide range of Aluminium profile extrusions in finishes that suit functional modern design specifications. The company has left its mark on the architectural landscape of the Middle East with its renowned quality products being used in a number of prominent structures.

Our annual production capacity is 42,000 MT with four (4) state of the art presses. The extrusion presses are complemented by one anodizing line and two powder coating lines (vertical & horizontal). NAPCO also houses two wood finish lines and a crimping and bending facility.

NAPCO's commitment to quality has made it the first extrusion company in the Gulf to receive ISO certifications. We are also the only public limited aluminium extrusion company in the entire GCC.

With a consistent focus on innovative production skills and high service standards, we will continue our objective to meet customer demands and expectations.

Technical Information on Aluminium extrusions supplied by NAPCO

A. Equipment & Capacity

Extrusion Press: 4
2000 MT (8') SMS Germany
2800 MT (9') Danieli Breda, Italy
1800 MT (7') Tecalex, Spain
1800 MT (7') Tecalex, Spain

Powder Coating Plant: 2
Horizontal Type, Ercon, UK
Vertical Type, Trasmetal, Italy

Anodizing Line: 1

SAS, Germany

Wood Finish: 2 NATURALL, Italy.
Crimping & Bending Facility.

• Current Capacity Per Annum

Extrusion: 42,000
Powder Coating: 27,000
Anodizing: 2,400
Wood Finish: 1,500

B. General Specification

Max profile size CCD 305mm
(*indicative size)

C. Product Range

NAPCO offers a range of over 6000 profiles to suit the architectural and manufacturing industry. NAPCO also develops exclusive dies for customers against their own designs.

• Aluminium extrusions in:

Mill Finish
Anodized
Powder Coated and Natural Wood Finish

• Façade Systems:

NAPCO is in partnership with world renowned façade system houses in the GCC. Please contact us to discuss your best-fit solution.

D. Anodizing

NAPCO has one anodizing line employing sulphuric acid anodizing process offering a wide range of colour shades such as Silver, Bronze and Black with scope of development of other shades to suit customer requirements.

Specifications: DC Sulphuric Acid Anodizing
As per EN 1 - 12373 and BS 1991 3987
Qualanod Approved

E: Powder Coating

NAPCO has two powder coating lines (horizontal & Vertical) with IR curing ovens. The colour coat thickness in exposed areas is Around 80-60 microns. The new vertical line is able to accommodate profile lengths up to 8 meters.

Qualicoat Approved.

Natural finish is available in seven combinations of Wood patterns.

Specification: As per 6496

F. Certifications



N 70.2 MM SERIES



N 70.2 mm Series

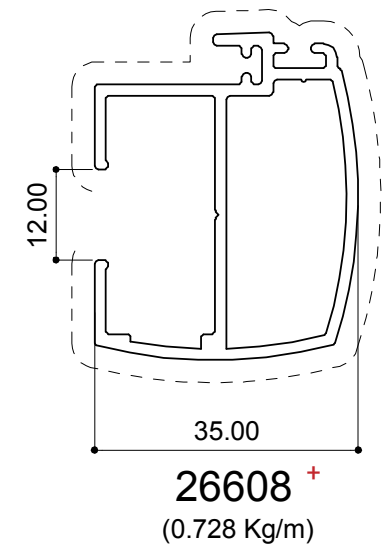
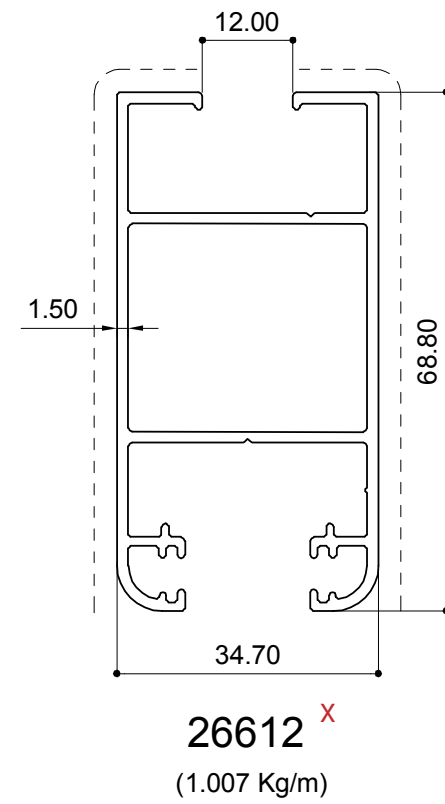
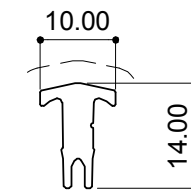
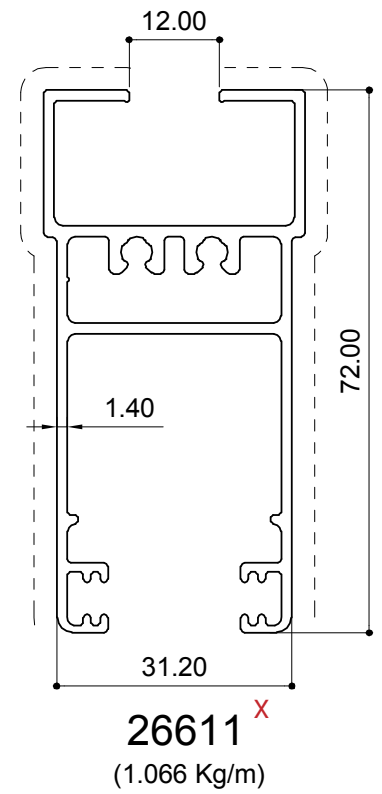
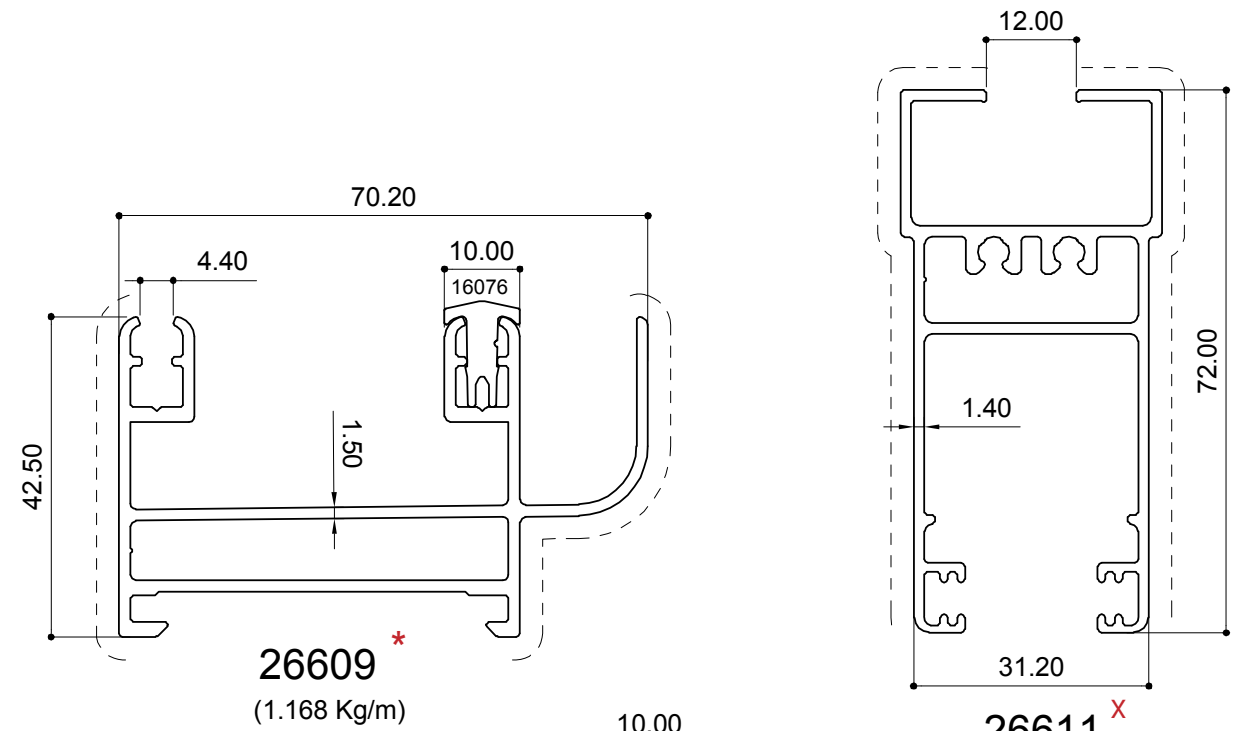

* Frame, + Interlock, X Sash

N 70.2 mm Series

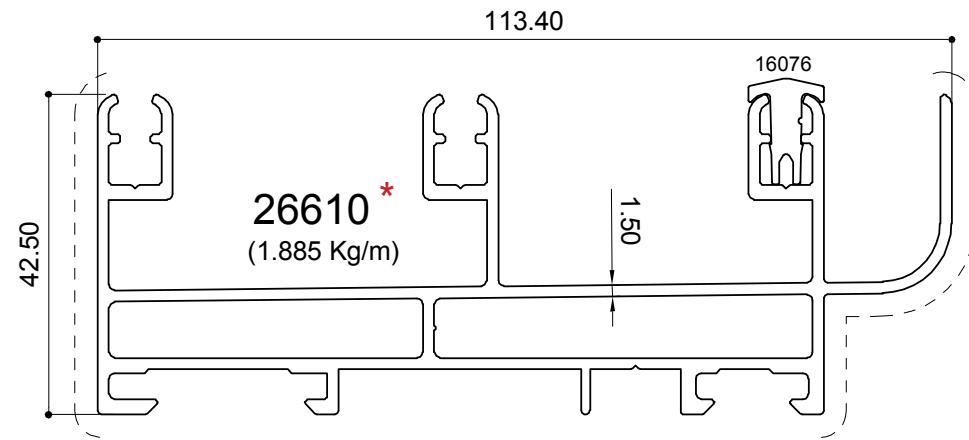

26610*
(1.885 Kg/m)

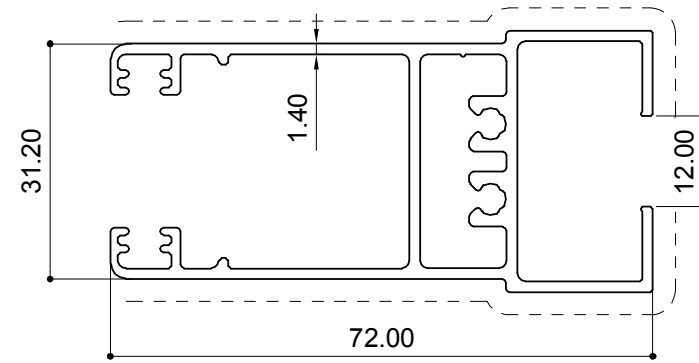

26611^X
(1.066 Kg/m)

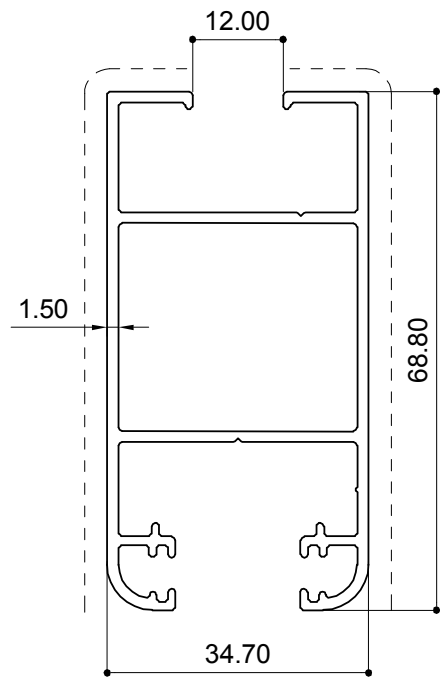

26612^X
(1.007 Kg/m)

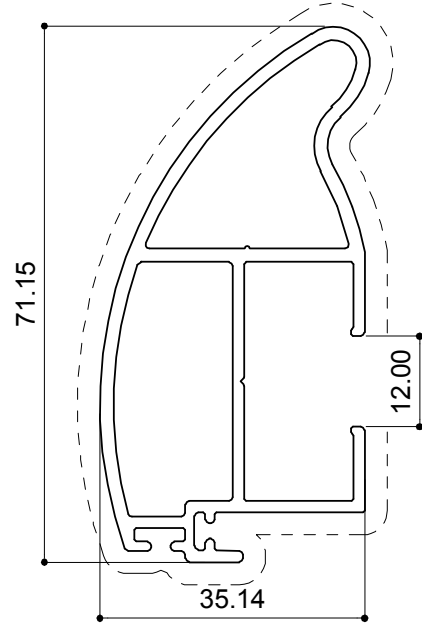

26616⁺
(1.106 Kg/m)

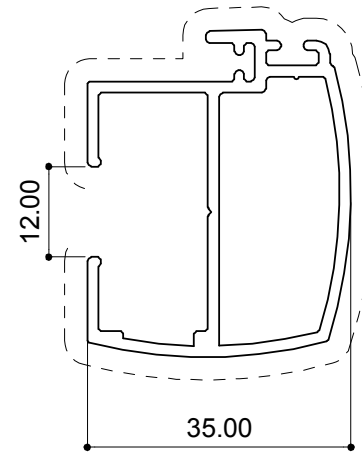

26608⁺
(0.728 Kg/m)

* Frame, + Interlock, X Sash

N 70.2 mm Series

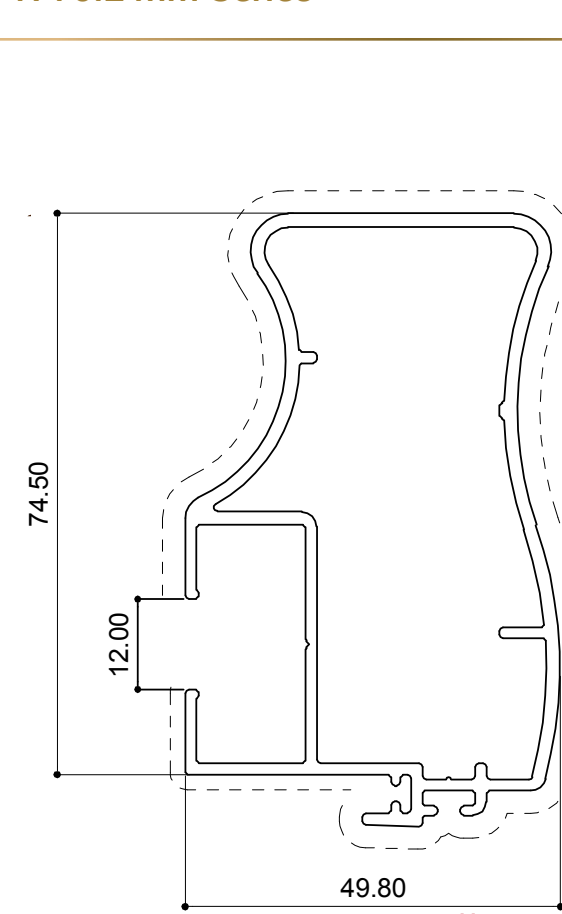

26613^X
(1.379 Kg/m)

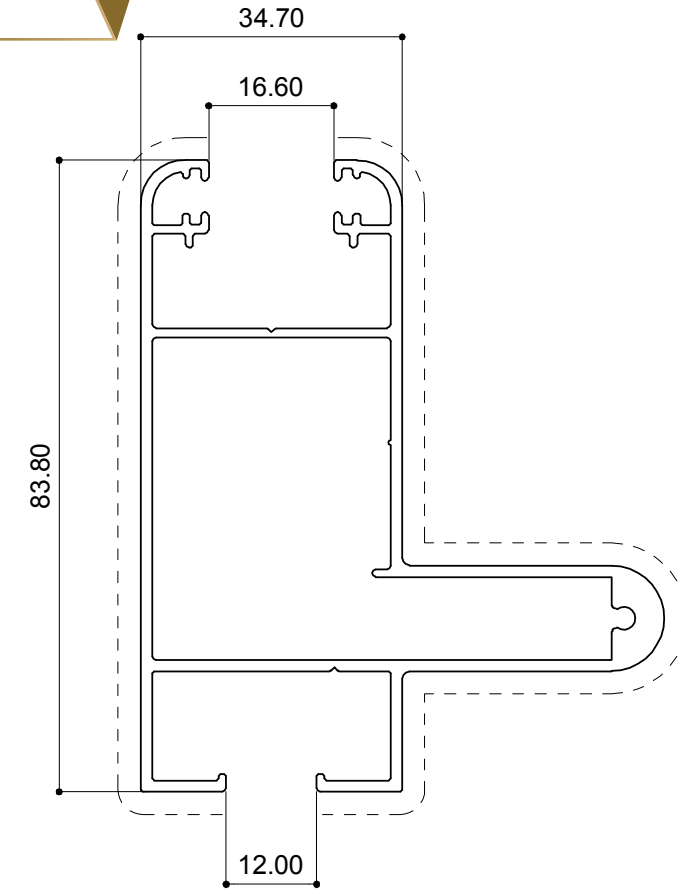

26615^X
(1.494 Kg/m)

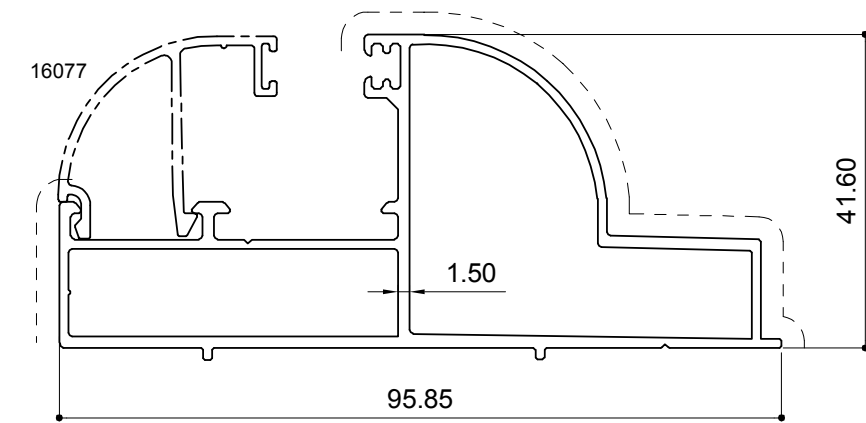

26614*
(1.117 Kg/m)

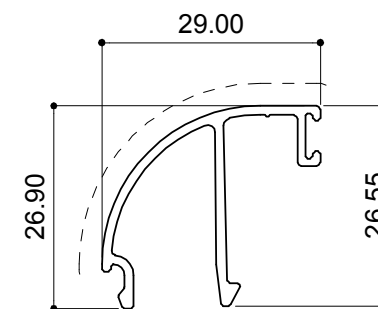

16077^X
(0.284 Kg/m)

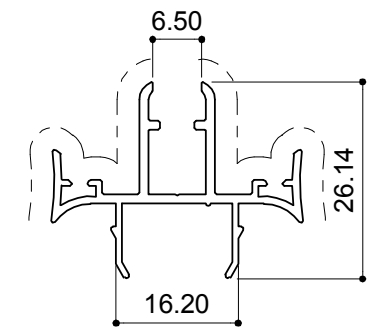

16078^X
(0.319 Kg/m)

* Frame, + Interlock, X Sash

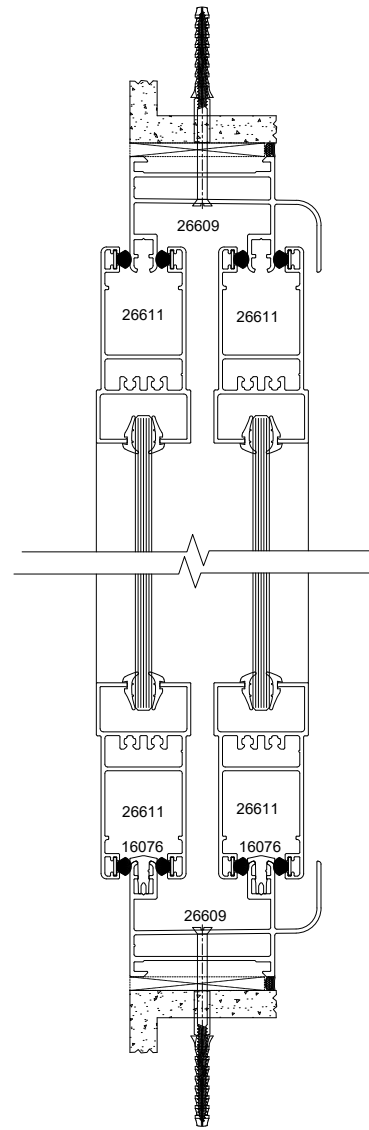
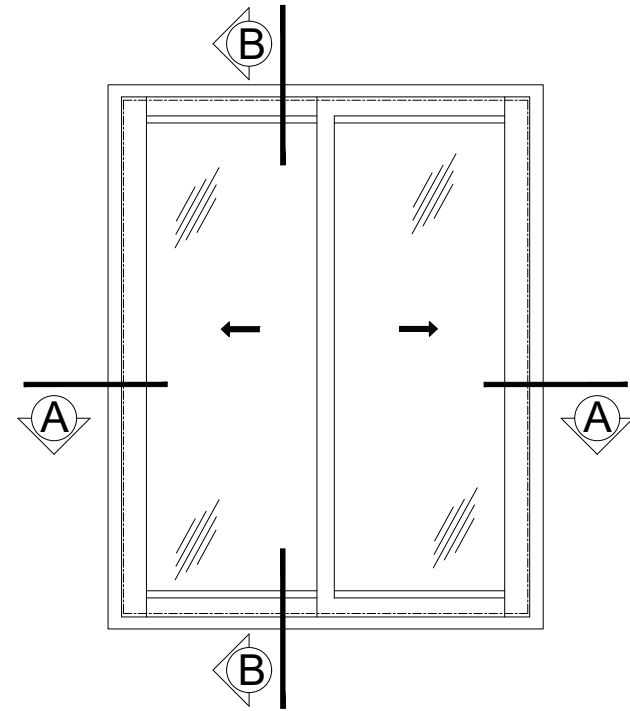

DETAIL SECTION - 'BB'

PROFILES		
Description	Shape	Section No.
Frame side		26609
Bottom Sash		26611
Side Sash		26612
Interlock		26608
Adaptor		16076

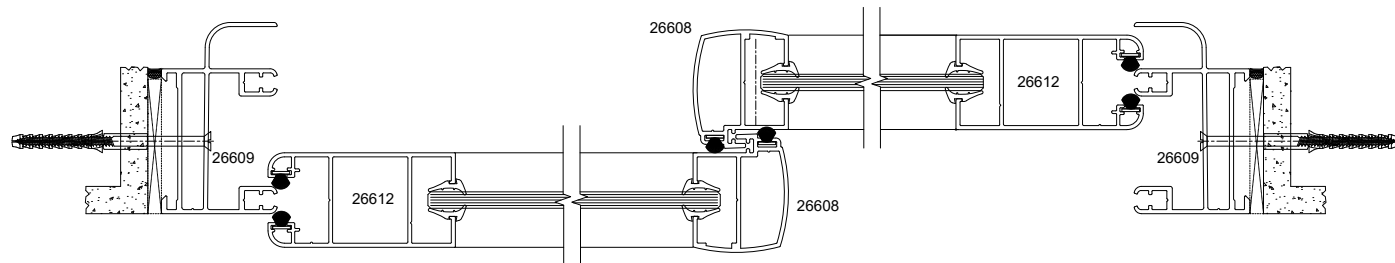

DETAIL SECTION - 'AA'

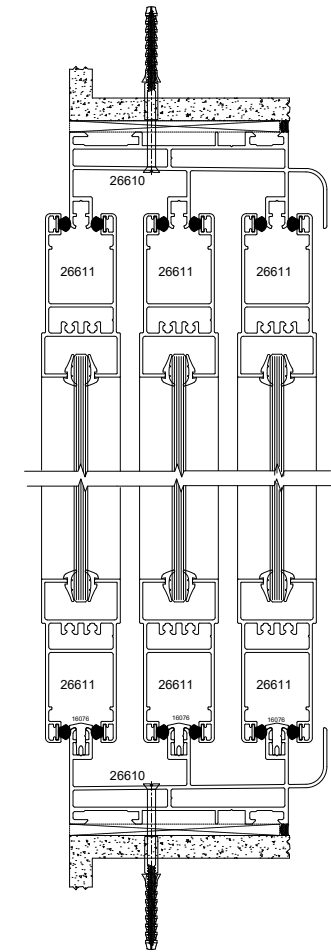
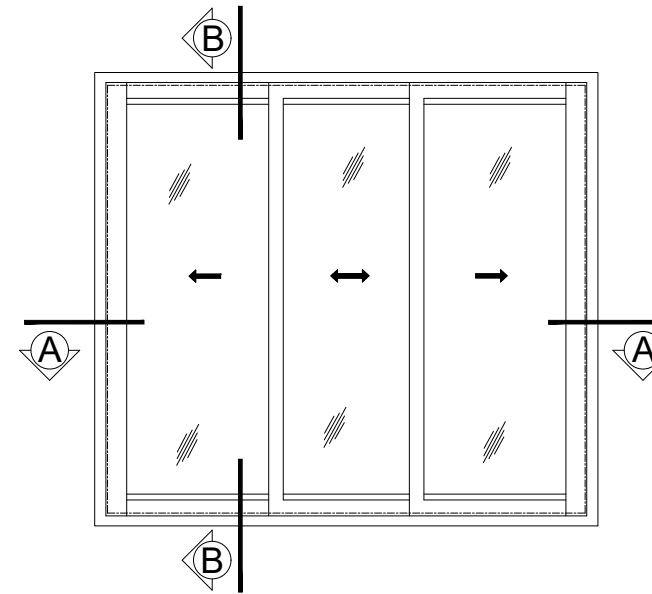

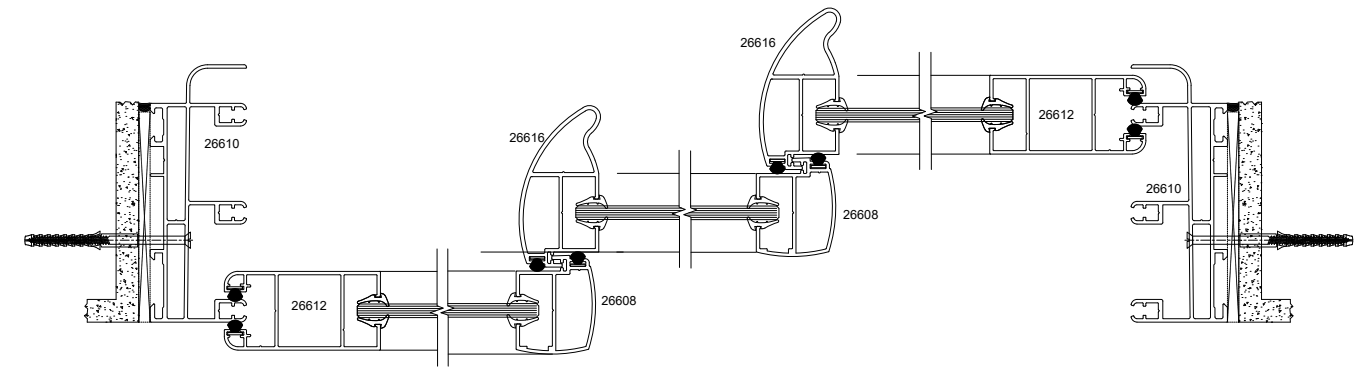

DETAIL SECTION - 'BB'

PROFILES		
Description	Shape	Section No.
Frame		26610
Bottom Sash		26611
Side Sash		26612
Interlock		26616
Interlock		26608
Adaptor		16076

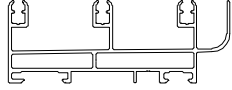
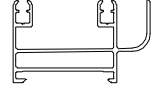
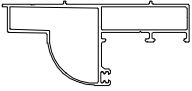
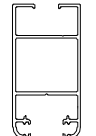
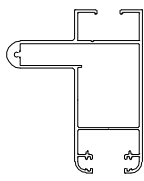
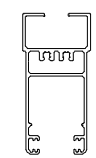
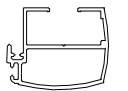
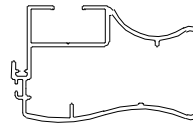
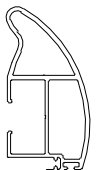

DETAIL SECTION - 'AA'

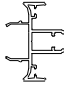
Profile Reference No:	Profile Section	Weight - Kg/m	IX	IY	WX	WY
26610		1.885	9.328 cm ⁴	88.192 cm ⁴	3.789 cm ³	14.677 cm ³
26609		1.168	5.801 cm ⁴	23.571 cm ⁴	2.488 cm ³	6.017 cm ³
26614		1.117	6.732 cm ⁴	29.362 cm ⁴	4.573 cm ³	5.922 cm ³
26612		1.007	17.452 cm ⁴	7.351 cm ⁴	5.062 cm ³	4.235 cm ³
26615		1.494	34.567 mm ⁴	27.037 mm ⁴	7.407 cm ³	6.453 cm ³
26611		1.066	17.448 cm ⁴	6.448 cm ⁴	4.412 cm ³	3.716 cm ³
26608		0.728	5.99 cm ⁴	3.447 cm ⁴	2.188 cm ³	1.794 cm ³
26613		1.379	13.870 cm ⁴	36.511 cm ⁴	5.261 cm ³	8.726 cm ³
26616		1.106	18.144 cm ⁴	5.261 cm ⁴	4.781 cm ³	2.869 cm ³

Profile Reference No:	Profile Section	Weight - Kg/m	IX	IY	WX	WY
16078		0.319	-----	-----	-----	-----
16076		0.159	-----	-----	-----	-----
16077		0.284	-----	-----	-----	-----



**NATIONAL ALUMINIUM
PRODUCTS COMPANY SAOG**

OMAN

Corporate Office and Factory
National Aluminium Products Co.
PO Box 15, Rusayl, PC 124, Sultanate of Oman
Phone: 00968-24446450, Fax: 00968-24446453
Email: sales@napco.co.om, info@napco.co.om

UNITED ARAB EMIRATES

Branch Office - Dubai
National Aluminium Products Co.
PO Box 116912, Dubai, United Arab Emirates
Phone: 009714-3354531, Fax: 009714-3355728

www.napcooman.com